



# **ICON PEB STEEL (BD) LTD.**

**PRE-FABRICATED STEEL BUILDING MANUFACTURER**

**SAFETY  
ECONOMY  
SUSTAINABILITY**

# MESSAGE FROM MANAGING DIRECTOR

**Assalamu Alaikum,**

Icon Peb Steel (BD) Ltd. As the name implies is a modern and state of the art Pre-Engineered Steel Fabrication and Construction Company.

The company was started by a core group of highly experienced team of engineers who felt that the existing

companies were not doing justice to the comparatively new industry. We provide to deliver quality buildings at competitive prices and within a short period of 7 years, we have carved out a niche in the market.



Our motto has been and will be Quality, Timely delivery and price. To the motto, I want to add, ethical way to doing business. On behalf of the Board of Directors and myself, I take this opportunity to present our company and our capabilities for your consideration. Bangladesh has a vibrant economic with a huge potential for growth. We want to contribute to that growth. I wish our old and new clients, our well-wishers, our business partners, our suppliers, Bankers, and most importantly our officers and workers my sincerest gratitude for their contribution to our success and hope our friendly relationship will grow further and will contribute to our mutual benefit in the days and years to come.

We are looking forward to our customers' valued order and we promise highest quality, at a competitive price, quick delivery and effective after sales service such that we can expect

Thank you

A handwritten signature in black ink, appearing to be 'Y. Khan'.

**Engr. Younus Khan**  
Managing Director  
Icon Peb Steel (BD) Ltd



## BOARD OF DIRECTOR

We are looking forward to our customers' valued order and we promise highest quality, at a competitive price, quick delivery and effective after sales service such that we can expect.



**Shadat Zaman**  
Chairman



**Engr. Younus Khan**  
Managing Director



**Engr. Bashir Hossen**  
Director

## DESIGN CODE

The buildings are designed in accordance with the following codes :

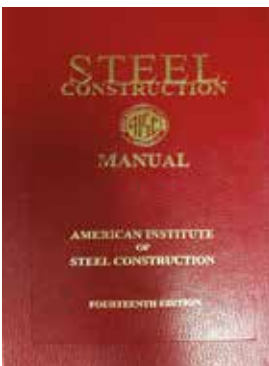
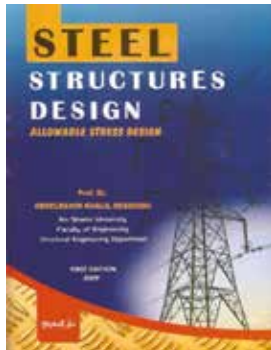
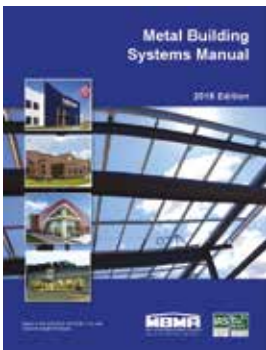

### A. Load are Applied in Accordance with :

- ⦿ BNBC-2020 (Bangladesh National Building Codes)
- ⦿ MBMA-2005 (Metal Building Manufacturers Association)
- ⦿ IBC-2009 (International Building Code)
- ⦿ ASCE-7-05 (American Society of Civil Engineers)

### B. Hot Rolled and built-up Sections are designed in accordance with :

- ⦿ American Institute of Steel Construction (AISC)
  - \* Steel Construction Manual
  - \* Design Guide
  - \* ASD and LRFD Method

### C. Cold-formed members are desinged in accordance with

- ⦿ AISI- (American Iron and Steel Institute)



## Advantages of Steel Structure

### Reduced Construction Time

"It can reduce total construction time on a project by at least 50% of conventional construction time. This will allow faster occupancy and earlier realization of revenue."

### Design

"Since PEB's are mainly form of standard sections and connections, the design time has been significantly reduced. Specialized computer analysis and design programs optimizes material requirement."

### Lower Cost

"Due to the systems approach, there is a significant saving in design, manufacturing and site erection cost. The structural elements are shaped to follow the stress diagram of the member, thus reducing weight, cost and load to foundations.

### Foundations

"PEB are about 30% lighter than the conventional structures. Hence, the foundations are of simple design, easy to construct and lighter weights."

### Quality Control

"As buildings are being manufactured completely in the factory under controlled conditions, the quality is assured."

### Large Clear Spans

"Buildings can be supplied to around 90M clear spans."

## OUR STRENGTH

- No compromise with quality.
- Best Possible Product
- Professional Sales & Customer Service
- Expertise in Engineering
- Excellence in Co-ordination and Team work



## OUR EXPERTISE.

- Industrial Building & Shed.
- Multi-storied Steel Building.
- Garments Factory.
- Showrooms & Rack Structures.
- Filling Station.
- Commercial Building
- Paper Mills.
- Textile & Spinning Mills.
- Shopping Mall
- Auto Rice Mills.
- Stadium.
- Bridge.
- Power station

# M.S Plate

# MATERIAL SPECIFICATIONS

Parameter		Min.mm	Max.mm
Flange	Width (B)	100	600
	Thickness (TF)	6	40
Web	Height (H)	100	1500
	Thickness (TW)	4.5	32
CP	Thickness (T)	12	70

Material : Hot Rolled Plates  
 Standard : ASTM A572 M Grade-50 (G-345)  
 Yield Strength : 345 Mpa  
 Surface : Red Oxide/Gray Oxide  
 Length : 6M/20 ft  
 Application : Column, Beam, Rafter, Bracing etc.



Hot Rolled Strip  
(by Gas Cutting or Sher Cutting)

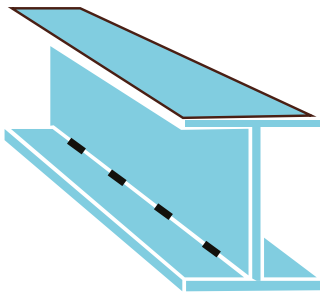

H-beam Assembling  
(by auto Spot Welding)

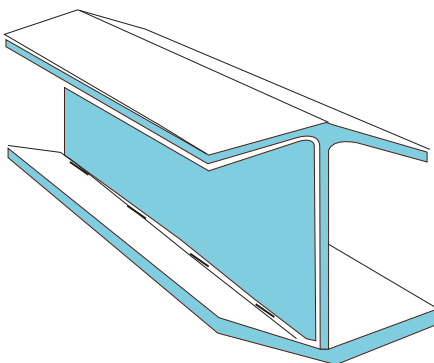

H-beam Fabrication Straighten  
(by submerge arc welding)

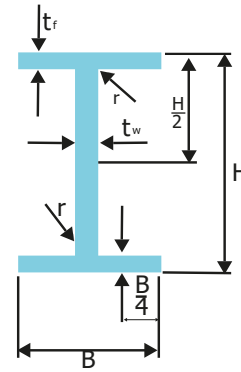

H-Beam Specification	
Material	Build Up Section
Standard	ASTM A572 M Grade-50 (G-345)
Yield Strength	345 Mpa
Ytimate Strength	450 Mpa

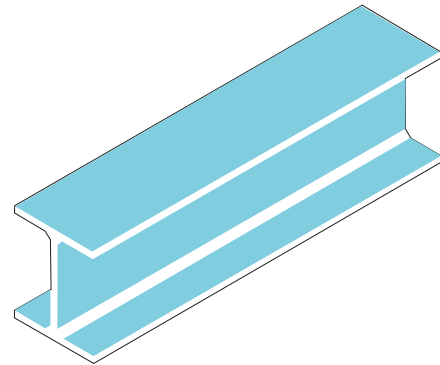

H-Beam Section

Geomertical moment of Inertia  $I = Ar^2$   
 Radius of gyration of Area  $r = \sqrt{I/A}$   
 Modulus of section  $Z = I/Y$   
 (A = Section Area)

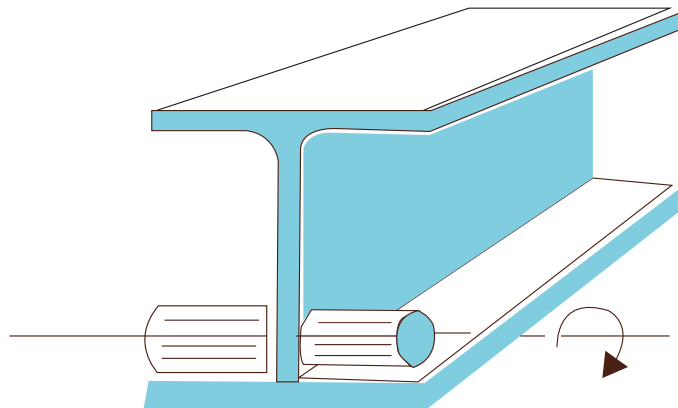

# STRUCTURAL ACCESSORIES



**Anchor Bolts**



**Color Coated Sheet**



**Nut Bolt**



**Fasteners**



**Wire Clip**



**Turn Buckle**



**Cable**



**Washer**



**Royal Bolts**



**Sag Rod**

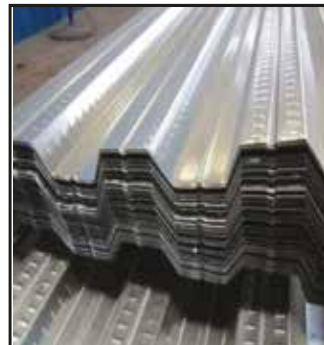

**Decking Panel**



**Purlin**



**Chequer Plate**



**Chemical Bolt**



**Natural Ventilation**



**Louver System**



# SHEETING ACCESSORIES



**Roof Monitor**



**Gravity Ventilator**



**Ridge Cap**



**Bottom Flashing**



**Bubble Insulation**



**PE-Foam Insulation**

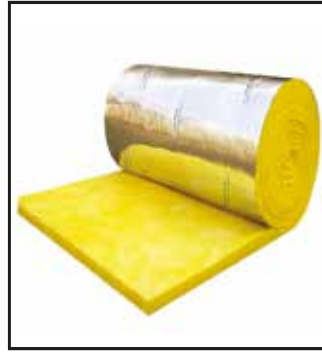

**Glass Wool Insulation**



**Rock Wool Insulation**

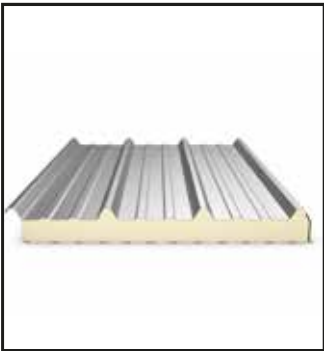

**Sandwich Panel**



**Sky Light Sheet**



**Exhaust Fan**



**Rain Water Pipe**



**Canopy System**



**Sliding Door System**



**Roller Shutter**



**Louver System**

# Our Factory



**Factory Shed Outer View**



**Factory Inner View**



# Factory Machineries



AUTO WELDING SAW MACHINE



MIG WELDING MACHINE

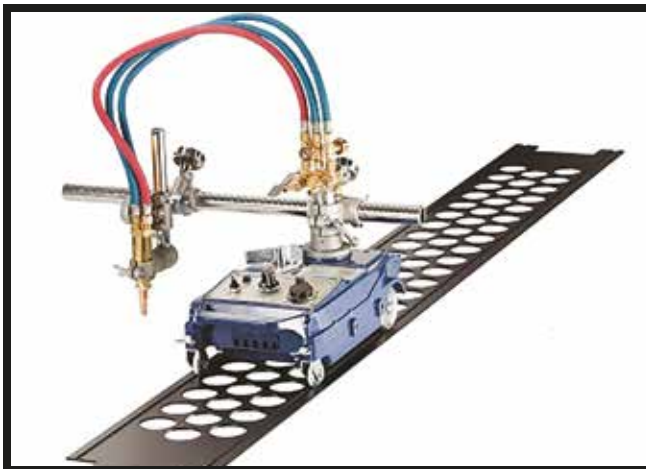

Auto Cutting Machine



Hydraulic Drill Machine



Gach Drill Machine



Magnetic Drill Machine

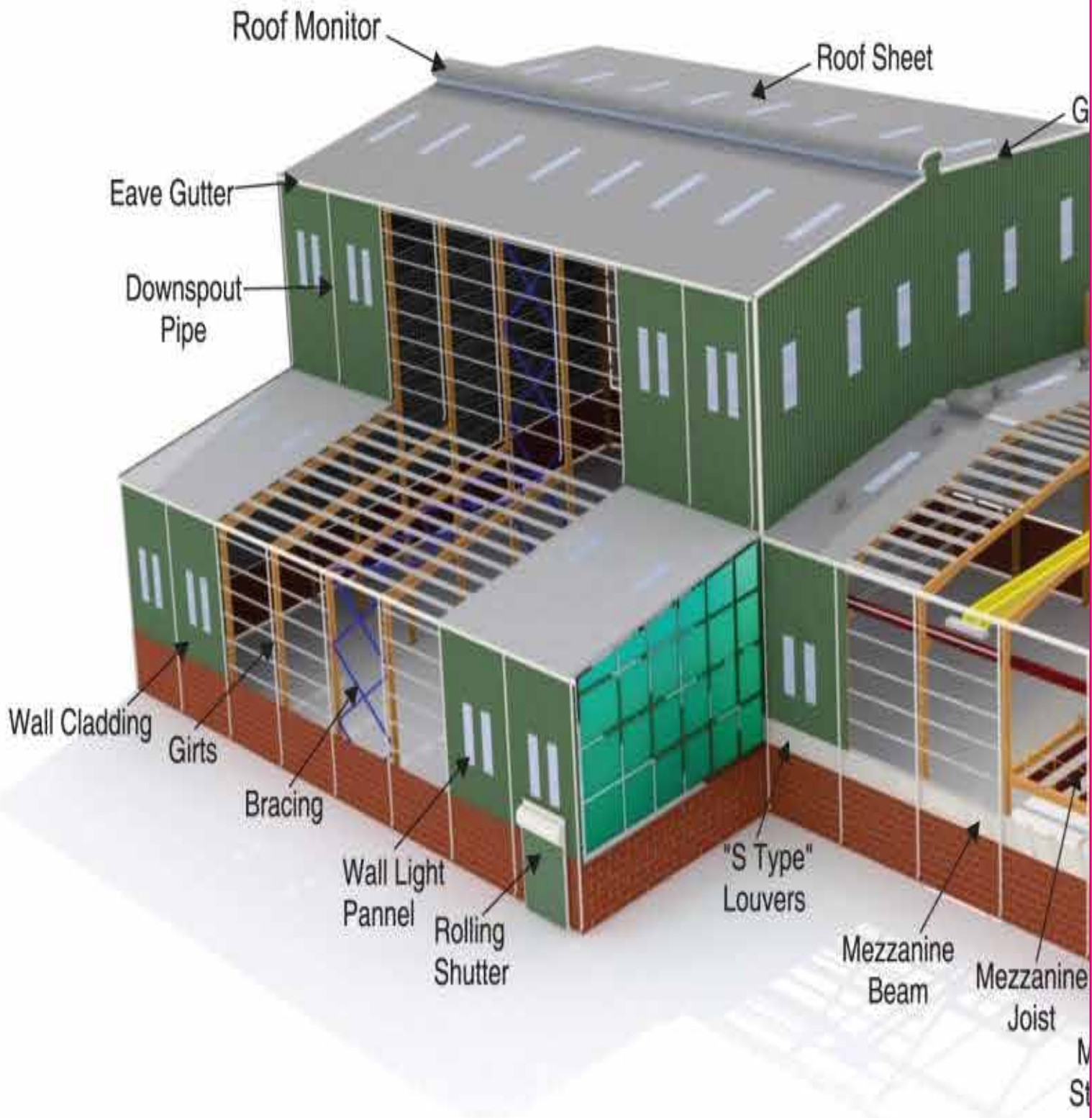



# STEEL BUILDING SYSTEM

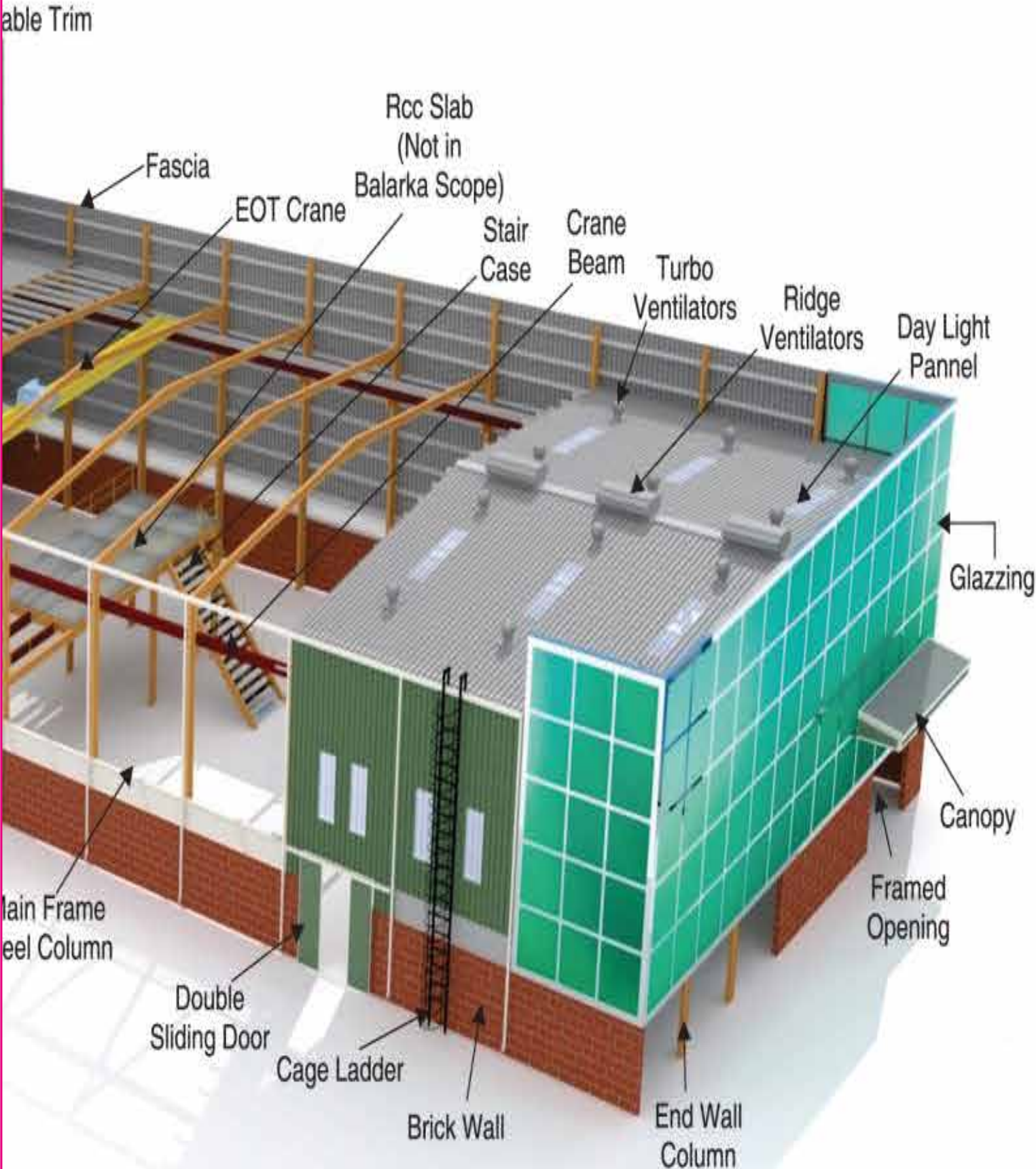



# PROJECTS

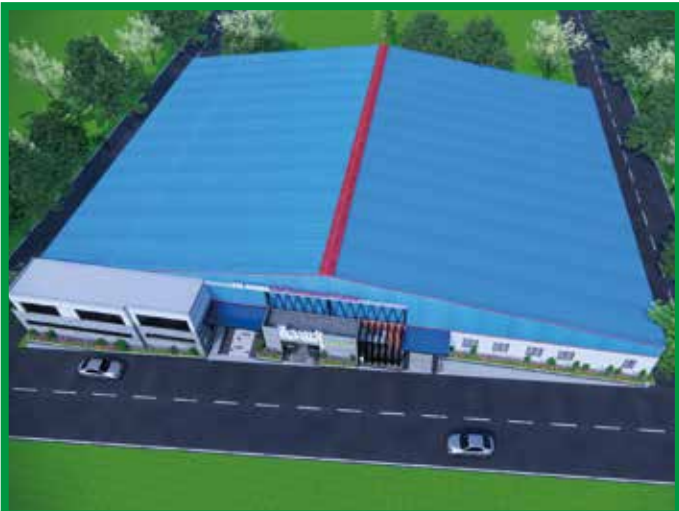

As-Sunnah Foundation , Sowdesh Project ,Aftab Nagor ,Dhaka



As-Sunnah Foundation , Sowdesh Project ,Aftab Nagor ,Dhaka



Pepsi Warehouse ,Birulia ,Savar ,Dhaka



Pepsi Warehouse ,Birulia ,Savar ,Dhaka



Steel King Industries , Gazipura ,Gazipur



Lipy Paper Mills Ltd., Sonargaon, Narayanganj.



# PROJECTS



**Poly Cable Industries Ltd., Munshiganj.**



**Habib Paper Mills Limited, Rupgonj, Narayanganj.**

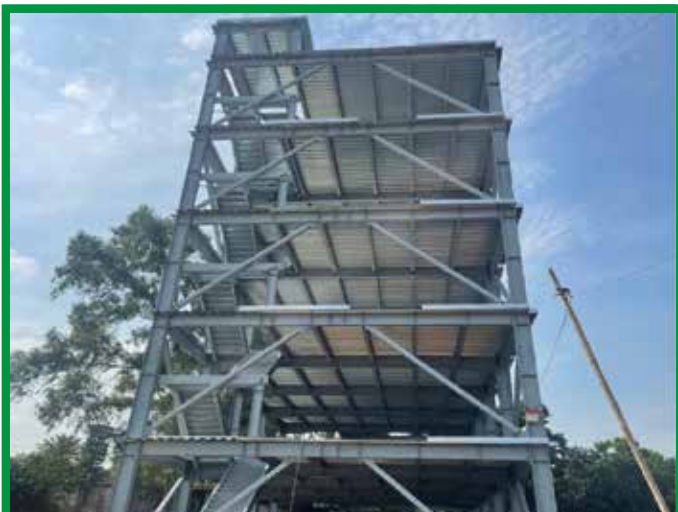

**Smart Knit, Gawsia Narayanganj**



**SR Chemical Industries Ltd., Serajganj.**



**Smart Vivo Mobile Factory, Narayanganj**



**Tex Zippers (BD) Ltd. (Zipper Unit), Adamjee EPZ, Narayanganj.**





# PROJECTS



**Irfan Market, New Market, Khulna.**



**Irfan Market, New Market, Khulna.**



**Robin Printing & Packages Ltd., Sreepur, Gazipur.**



**Robin Printing & Packages Ltd., Sreepur, Gazipur.**



**BSB Global Network**



**Anan Chemical Industries Ltd., Singair, Manikganj.**



# PROJECTS



Metro Food & Beverage Ltd., Beribadh, Mirpur, Dhaka.



Metro Express Courier Services, Hemayetpur, Savar, Dhaka.



MR Brothers , Matidali , Bogura



FB Footwear Central Mosque , Kaliakoir, Gazipur



RAS Cement industries Ltd, Konabari ,Gazipur.



Windy Terrace Cox's Bazar





# PROJECTS



**Nilima Bag Mills Ltd., Singair, Manikganj.**



**Royal Toiletries Ltd., Sonargaon, Narayangonj.**



**Halim Cottage, Jatrabari**



**Mondol Tower., Jhiltuli, Faridpur.**



**Pasha Group, Sonargaon, Narayangonj.**



**Duplex House, Chadpur**

## Some of Our Valued Clients

As Sunnah Foundation	Aftab Nagor, Dhaka	43,000
Transcom beverages Ltd. (PESI)	Biruliya, Savar, Dhaka	60,000
Smart Technologies (BD) Ltd.	Gawsia, Narayanganj	1,92,000
Abed Holdings Ltd.	Purana Palton, Dhaka	20 Storied Lift Core
Lipy Paper Mills Group	Sonargaon, Narayanganj	80,000
FB Foodwear Ltd.	Kaliakair, Gazipur	60,000
Nitol-Niloy Group	Sirajganj	30,000
Samsung C & T	The third Terminal	20,000
Sinhydro	Matar Bari, Cox's Bazar	40,000
Audi	Tajgoan, Dhaka	10,000
BSB Global Network	Akhaura, Brahmanbaria	60,000
Poly Cables	Gazaria, Munshiganj	62,000
APS Apparels Ltd.	Tongi, Gazipur	60,000
Reverie Power & Automation Engineering Ltd.	Sirajganj	20,000
Robin Printing & Packages Ltd.	Sreepur, Gazipur	64,000
Bangladesh Biman Bahini	Tajgoan	10,000
Ideal Products	Matuail, Dhaka	28,000
Windy Terrage	Kolatoli Cox's Bazar	14 Storied Lift Core
Vertex Group	Munshiganj	50,000
Steel King Industries	Targach, Gazipur	60,000
The Peninsula Chittagong	Patanga, Chattagram	40,000
Ujjal Flour Mills.	Demra, Dhaka	34,000
Metro Food & Beveage	Mirpur, Dhaka	82,000
Lecture Publication	Matuail, Dhaka	30,000
Nilima Bag Industries Ltd.	Singair, Manikganj	40,000
Anan Chemical Mills Ltd.	Singair, Manikganj	34,000
Ayan Properties Ltd.	Ashulia, Dhaka	40,000
MR Brothers Ltd.	Bogura	15,000
Euro Marble and Granite	Dohar, Dhaka	25,000
Tabassum Pringing & Pakaging	Keraniganj	50,000
Mita Group	Gausia, Narayanganj	40,000
Habib Paper Mills	Rupganj, Narayanganj	80,000
Ras Cement Industries	Konabari, Gazipur.	50,000
Irfan Market	Khulna	8 Storied
Halim Cottage	Jatrabari	8 Storied
Soudagor Express Ltd.	Keraniganj, Dhaka	30,000
Agata Feed Mills Ltd.	Chandina, Cumilla	50,000





## Certificate of Incorporation (under Act XVIII of 1994)

No. C-193858/2024

*I hereby certify that **ICON PEB STEEL (BD) LTD.** is this day incorporated under the Companies Act (Act XVIII) of 1994 and that the Company is Limited.*

*Given under my hand at **Dhaka** this **Twenty-Second** day of **February** two thousand and twenty-four.*

*By order of  
Registrar*

*Assistant Registrar  
Registrar of Joint Stock Companies & Firms  
Bangladesh*



N.B. This certificate is digitally signed. Please find the soft copy to verify the signature.



## Our Valuable Client







**ICON PEB STEEL  
(BD) LTD.**

PRE-FABRICATED STEEL BUILDING MANUFACTURER

**Office Address:**

House No-09, Flat No-B3  
Road No-05, Block-J  
Banasree  
Dhaka-1212

**Factory :**

84, Trimohoni, Madrasha  
Road, Nandipara, Khilgaon,  
Dhaka-1219  
Bangladesh.

**ICON PEB STEEL (BD) LTD.**

**PRE-FABRICATED STEEL BUILDING MANUFACTURER**

**“Good Quality Good Relationship”**